

THE ROUTE SHOWN HERE IS NOT THE RECOMMENDED ROUTE FOR THE PROPOSED HIGH SPEED RAIL LINK

For Continuation Refer To HS2-ARP-07-DR-RW-021 07

For Continuation Refer To HS2-ARP-07-DR-RW-021 05

Plan  
Scale 1:10000

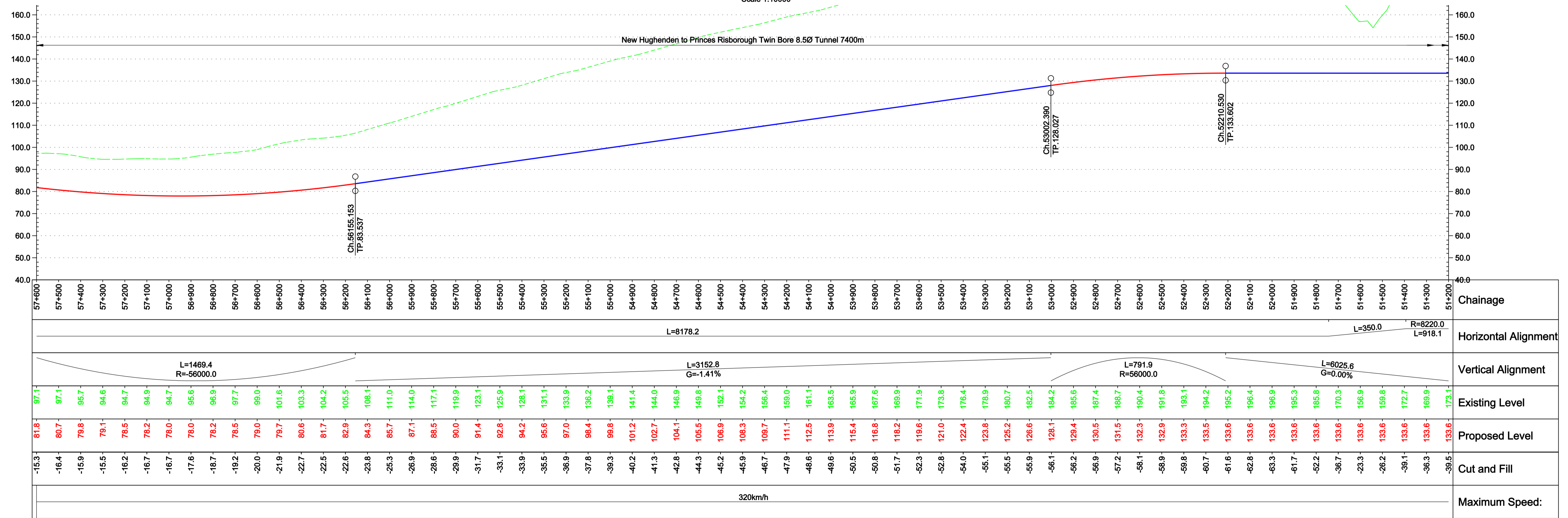

Profile  
Scale H 1:10000 V 1:1000

Reproduced by permission of the Ordnance Survey on behalf of Her Majesty's Stationary Office © Crown copyright and database right 2009. All rights reserved. Ordnance Survey Licence number 0100049190.

Environmental Features Legend	
Listed buildings	Special Areas of Conservation
Area of Outstanding Natural Beauty	Special Protection Areas
RAMSAR	National Nature Reserves
World Heritage Site	Parks and Gardens
SSSI	Scheduled Ancient Monuments
	Historical Battlefields
National Parks	Flood Risk Zones

**Notes**

- For notes and legend information refer to the keyplan information on drawing no.: HS2-ARP-07-DR-RW-02100
- For an outline summary of material and ground conditions present beneath scheme refer to final report.

Issue	Date	By	Chkd	Appd
3.0	22/04/10	CO	CL	PH
Watermark & Additional Annotation Shown				
2.0	18/11/09	TS	CL	PH
Additional Features Added				

Client:

Job Title: High Speed 2 Feasibility Study

Scale at A1: 1:10000

Discipline: Civil Railways

**ARUP**

The Arup Campus, Blythe Gate, Blythe Valley Park  
Salford, West Midlands B90 3AE  
T +44(0)121 213 3000 F +44(0)121 213 3001  
www.arup.com

Drawing Title: Route 2.5 Plan and Profile Sheet 6 of 12

Drawing Status: For Co-ordination

Drawing No: HS2-ARP-07-DR-RW-02106

Job No: 209742-00

Issue: 3.0