

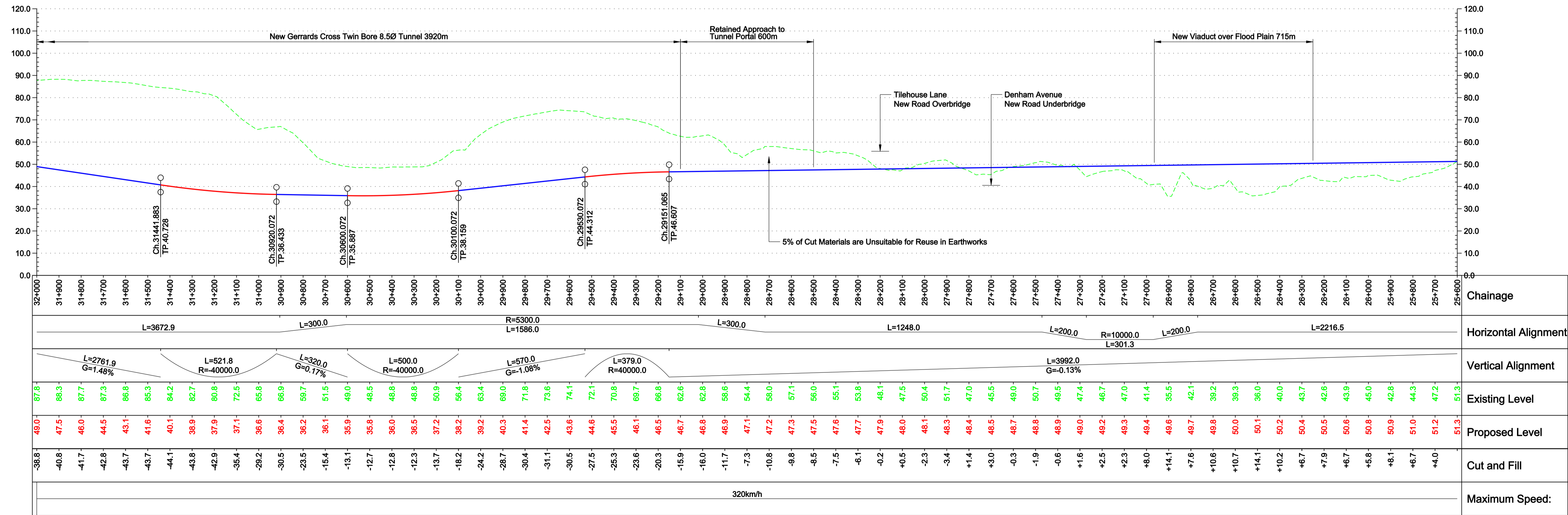

Plan
Scale 1:10000



Profile
Scale H 1:10000 V 1:1000

Reproduced by permission of the Ordnance Survey on behalf of Her Majesty's Stationary Office © Crown copyright and database right 2009. All rights reserved. Ordnance Survey Licence number 0100049190.

Environmental Features Legend

- Listed buildings
- Area of Outstanding Natural Beauty
- RAMSAR
- World Heritage Site
- SSSI
- Special Areas of Conservation
- National Protection Areas
- National Nature Reserves
- Parks and Gardens
- Scheduled Ancient Monuments
- Historical Battlefields
- National Parks
- Flood Risk Zones

Notes

- For notes and legend information refer to the keyplan information on drawing no.: HS2-ARP-07-DR-RW-02100
- For an outline summary of material and ground conditions present beneath scheme refer to final report.

Issue	Date	By	Chkd	Appd
3.0	22/04/10	CO	CL	PH
Watermark & Additional Annotation Shown				
2.0	18/11/09	TS	CL	PH
Additional Features Shown				

Client: **hs2**

Job Title: **High Speed 2 Feasibility Study**

Scale at A1: 1:10000

Discipline: **Civil Railways**

ARUP

The Anp Campus, Blythe Gate, Blythe Valley Park
Salford, West Midlands B90 3AE
T +44(0)121 213 3000 F +44(0)121 213 3001
www.arup.com

Drawing Title: **Route 2.5 Plan and Profile Sheet 2 of 12**

Drawing Status: **For Co-ordination**

Job No: **209742-00**

Drawing No: **HS2-ARP-07-DR-RW-02102**

Issue: **3.0**